

REPLACEMENT PARTS SUITABLE FOR
HYPERTHERM[®]

POWERMAX 1000[®]/POWERMAX 1250[®]/POWERMAX 1650[®]
T60[®]/T60M[®], T80[®]/T80M[®], T100[®]/T100M[®] shielded

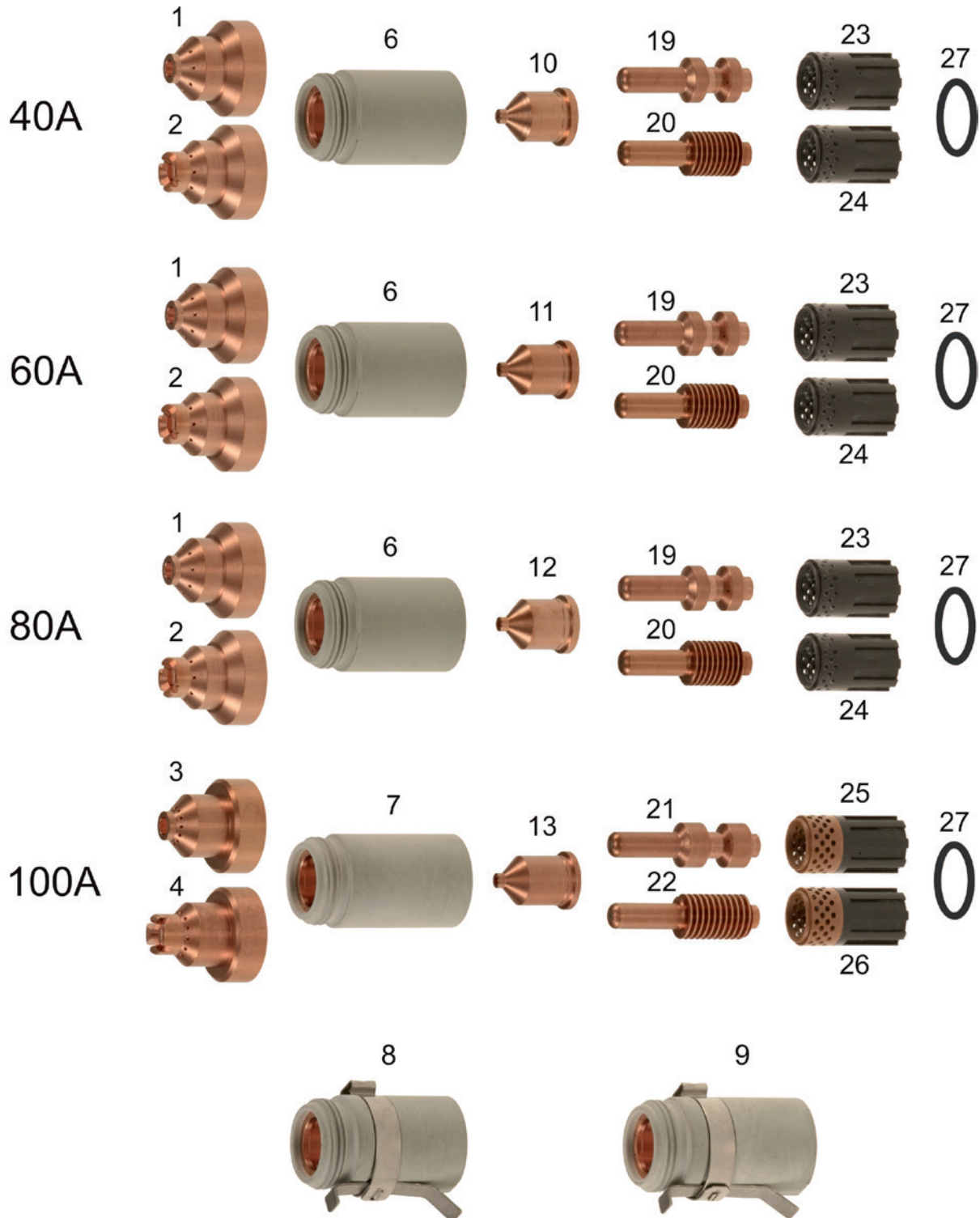

HYPERTHERM[®], Powermax1000[®]/Powermax1250[®]/Powermax1650[®]/PowermaxT60[®]/PowermaxT60M[®], PowermaxT80[®]/PowermaxT80M[®], Powermax T100[®]/PowermaxT100M[®], FineCut[®] are the Registered Trademarks of HYPERTHERM, Inc.

REPLACEMENT PARTS SUITABLE FOR
HYPERTHERM®

**POWERMAX 1000®/POWERMAX 1250®/POWERMAX 1650®
T60®/T60M®, T80®/T80M®, T100®/T100M® shielded**

Item	Part No.	Ref. No.	Description	Std. Pkg	Item	Part No.	Ref. No.	Description	Std. Pkg.
1.	T-9831**	120930-UR	Shield 40A/60A/80A	1	13.	T-8892	220011	Nozzle 100A	1
2.	T-9830**	120929-UR	Shield 40A/60A/80A	1	19.	T-4454**	120926-UR	Electrode 40A/60A/80A	5
3.	T-9832**	220047-UR	Shield 100A	1	20.	T-8401	120926	Electrode 40A/60A/80A	5
4.	T-9833**	220065-UR	Shield 100A	1	21.	T-4455**	220037-UR	Electrode 100A	5
6.	T-9880**	120928-UR	Retaining Cap 40A/60A/80A	1	22.	T-8872	220037	Electrode 100A	5
7.	T-9881**	220048-UR	Retaining Cap 100A	1	23.	T-4456**	120925-UR	Swirl Ring 40A/60A/80A	1
8.	T-10244**	220061-UR	Retaining Cap, Ohmic 40A/60A/80A	1	24.	T-8400	120925	Swirl Ring 40A/60A/80A	1
9.	T-10245**	220206-UR	Retaining Cap, Ohmic 100A	1	25.	T-4457**	220051-UR	Swirl Ring 100A	1
10.	T-3891	120932	Nozzle 40A	1	26.	T-9923	220051	Swirl Ring 100A	1
11.	T-8405	120931	Nozzle 60A	1	27.	T-4510	058519	O-Ring	1
12.	T-3890	120927	Nozzle 80A	1					

** A UNIQUE DESIGN WHICH ENHANCES PERFORMANCE AND DIFFERS FROM OEM DESIGNS

HYPERTHERM®, Powermax 1000®/Powermax 1250®/Powermax 1650®/Powermax T60®/Powermax T60M®, Powermax T80®/Powermax T80M®, Powermax T100®/Powermax T100M®, FineCut® are the Registered Trademarks of HYPERTHERM, Inc.

THERMACUT is in no way affiliated with the above-named manufacturers. References to the above-named machines, torches, consumables and reference numbers are for convenience only. Most Thermacut parts are made for or by an IBG company. Parts indicated with a * are original parts manufactured by the above named manufacturer and are being resold by Thermacut. Thermacut reserves the right to substitute OEM parts in place of Thermacut parts. Valid from July 2012 • Previous version is no longer valid. • © Copyright 2012 by Thermacut® Czech Republic. All rights reserved.

REPLACEMENT PARTS SUITABLE FOR
HYPERTHERM[®]

POWERMAX 1000[®]/POWERMAX 1250[®]/POWERMAX 1650[®]
T60[®]/T60M[®], T80[®]/T80M[®], T100[®]/T100M[®]unshielded

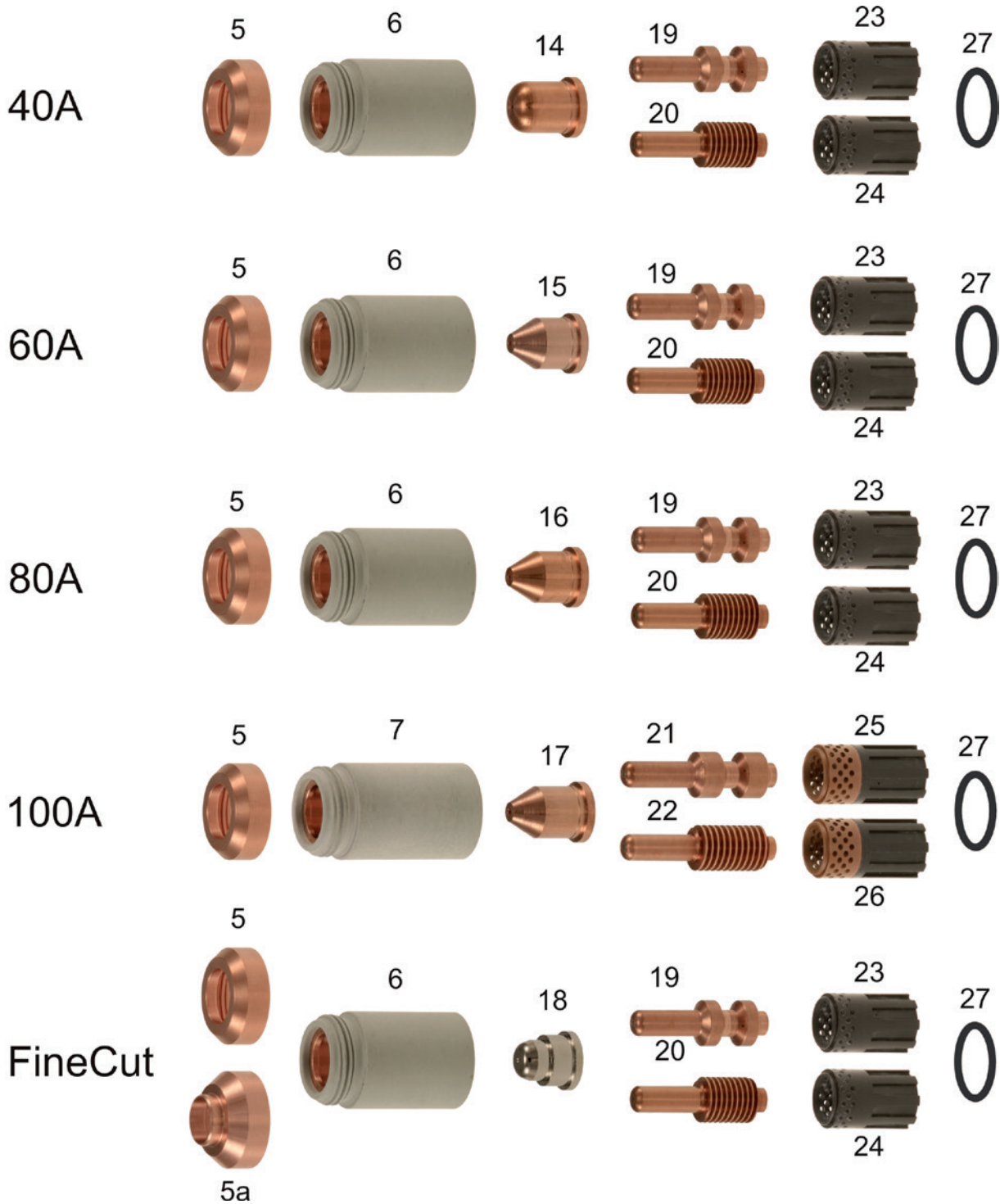

HYPERTHERM[®], Powermax1000[®]/Powermax1250[®]/Powermax1650[®]/PowermaxT60[®]/PowermaxT60M[®], PowermaxT80[®]/PowermaxT80M[®],Powermax T100[®]/
PowermaxT100M[®], FineCut[®] are the Registered Trademarks of HYPERTHERM, Inc.

REPLACEMENT PARTS SUITABLE FOR
HYPERTHERM®

**POWERMAX 1000®/POWERMAX 1250®/POWERMAX 1650®
T60®/T60M®, T80®/T80M®, T100®/T100M®unshielded**

Item	Part No.	Ref. No.	Description	Std. Pkg	Item	Part No.	Ref. No.	Description	Std. Pkg.
5.	T-4188	120979	Deflector 40A/60A/80A/100A	1	19.	T-4454**	120926-UR	Electrode 40A/60A/80A	5
5.a	T-10410*	220325 OEM	Deflector, CE 40A FineCut®	1	20.	T-8401	120926	Electrode	5
6.	T-9880**	120928-UR	Retaining Cap 40A/60A/80A	1	21.	T-4455**	220037-UR	Electrode 100A	5
7.	T-9881**	220048-UR	Retaining Cap 100A	1	22.	T-8872	220037	Electrode 100A	5
14.	T-3889	220006	Nozzle 40A Extended	1	23.	T-4456**	120925-UR	Swirl Ring 40A/60A/80A	1
15.	T-4572	220007	Nozzle 60A Extended	1	24.	T-8400	120925	Swirl Ring 40A/60A/80A	1
16.	T-3892	120980	Nozzle 80A Extended	1	25.	T-4457**	220051-UR	Swirl Ring 100A	1
17.	T-4190	220064	Nozzle 100A Extended	1	26.	T-9923	220051	Swirl Ring 100A	1
18.	T-9998	220329	Nozzle 40A FineCut®	1	27.	T-4510	058519	O-Ring	1

** A UNIQUE DESIGN WHICH ENHANCES PERFORMANCE AND DIFFERS FROM OEM DESIGNS

HYPERTHERM®, Powermax1000®, Powermax1250®, Powermax1650®, PowermaxT60®, PowermaxT60M®, PowermaxT80®, PowermaxT80M®, Powermax T100®, PowermaxT100M®, FineCut® are the Registered Trademarks of HYPERTHERM, Inc.

THERMACUT is in no way affiliated with the above-named manufacturers. References to the above-named machines, torches, consumables and reference numbers are for convenience only. Most Thermacut parts are made for or by an IBG company. Parts indicated with a * are original parts manufactured by the above named manufacturer and are being resold by Thermacut. Thermacut reserves the right to substitute OEM parts in place of Thermacut parts. Valid from July 2012 • Previous version is no longer valid. • © Copyright 2012 by Thermacut® Czech Republic. All rights reserved.

REPLACEMENT PARTS SUITABLE FOR
HYPERTHERM[®]

POWERMAX 1000[®]/**POWERMAX 1250**[®]
T60M[®]/**T80M**[®] machine torch

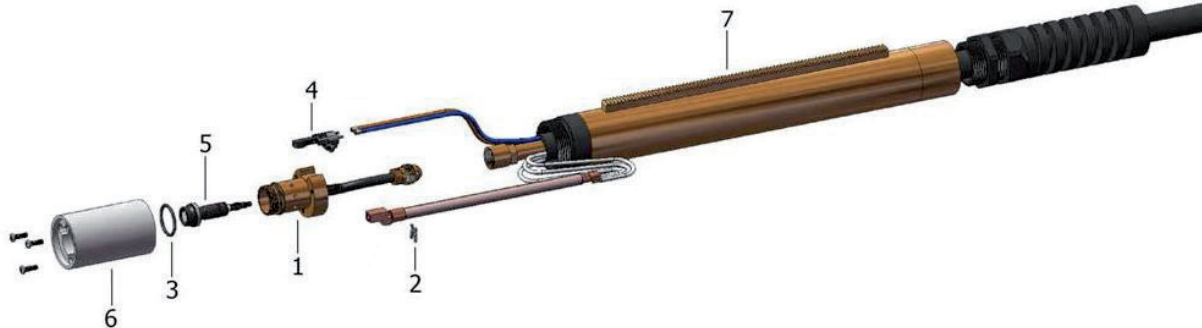

Item	Part No.	Ref. No.	Description	Std. Pkg.	Item	Part No.	Ref. No.	Description	Std. Pkg.
1.	T-10319**	128640-UR	T60M [®] /T80M [®] Torch Body Kit (Incl. items:2,3,5)	1	5.	T-10253**	128521-UR	T60 [®] , T80 [®] /T60M [®] , T80M [®] Torch Head Repair Kit	1
2.	T-10237*	027889 OEM	Retaining Clip	1	6.	PT-12161**	128643-UR	Torch Mounting Sleeve Replacement Kit With Screws	1
3.	T-4510	058519	O-Ring	1	7.	T-12159	128710	Torch Positioning Sleeve	1
4.	T-10615**	128639-UR	TMT Cap-off Sensor Replacement Kit With Screws	1	NS	T-10845	T-10845	T80M [®] Torch Body + Cap Sensor	1

POWERMAX 1000[®]/**POWERMAX 1250**[®]
T60[®]/**T80**[®] hand torch



Item	Part No.	Ref. No.	Description	Std. Pkg.	Item	Part No.	Ref. No.	Description	Std. Pkg.
1.	T-10281**	128564-UR	T60 [®] /T80 [®] Torch Body Kit (Incl. items:2,3,5)	1	7.	T-10849	T-10849	Trigger Switch	1
2.	T-10237*	027889 OEM	Retaining Clip	1	NS	T-10838	T-10838	T60 [®] /T80 [®] /T100 [®] Handle Repl. Assy	1
3.	T-4510	058519	O-Ring	1	NS	T-10839	T-10839	T60 [®] /T80 [®] Torch Handle Repl. Assy	1
4.	T-10615*	128639-UR	TMT Cap-off Sensor Replacement Kit With Screws	1	NS	T-10846	T-10846	T80 [®] Torch Body + Cap Sensor	1
5.	T-10253**	128521-UR	T60 [®] , T80 [®] /T60M [®] , T80M [®] Torch Head Repair Kit	1	NS	T-10849	T-10849	Trigger Assy With Microswitch	1
6.	T-10623**	128644-UR	TMT Handle Kit With Screws	1					

**A UNIQUE DESIGN WHICH ENHANCES PERFORMANCE AND DIFFERS FROM OEM DESIGNS

HYPERTHERM[®], Powermax 1250[®], Powermax T60M[®]/Powermax T80M[®], Powermax T60[®]/Powermax T80[®]
are the Registered Trademarks of HYPERTHERM, Inc.

REPLACEMENT PARTS SUITABLE FOR
HYPERTHERM®

POWERMAX 1650®
T100M® machine torch



Item	Part No.	Ref. No.	Description	Std. Pkg.	Item	Part No.	Ref. No.	Description	Std. Pkg.
1.	T-10446**	128754-UR	T100M® Torch Body Kit (Incl. items: 2, 3, 5)	1	5.	T-10473	128768-UR	T100®/T100M® Torch Head Repair Kit	1
2.	T-10237*	027889 OEM	Retaining Clip	1	6.	PT-12161**	128643-UR	Torch Mounting Sleeve Replacement Kit With Screws	1
3.	T-4510	058519	O-Ring	1	7.	T-12159	128710	Torch Positioning Sleeve	1
4.	T-10615**	128639-UR	TMT Cap-off Sensor Replacement Kit With Screws	1	NS	T-10847	T-10847	T100M® Torch Body + Cap Sensor	1

POWERMAX 1650®
T100® hand torch



Item	Part No.	Ref. No.	Description	Std. Pkg.	Item	Part No.	Ref. No.	Description	Std. Pkg.
1.	T-10444**	128767-UR	T100® Torch Body Kit (Incl. items: 2, 3, 5)	1	7.	T-10849	T-10849	Trigger Switch	1
2.	T-10237*	027889 OEM	Retaining Clip	1	NS	T-10838	T-10838	T60®/T80®/T100® Handle Repl. Assy	1
3.	T-4510	058519	O-Ring	1	NS	T-10840	T-10840	T100® Torch Handle Repl. Assy	1
4.	T-10615**	128639-UR	TMT Cap-off Sensor Replacement Kit With Screws	1	NS	T-10848	T-10848	T100® Torch Body + Cap Sensor	1
5.	T-10473**	128768-UR	T100®/T100M® Torch Head Repair Kit	1	NS	T-10849	T-10849	Trigger Assy With Microswitch	1
6.	T-10623**	128644-UR	TMT Handle Kit With Screws	1					

**A UNIQUE DESIGN WHICH ENHANCES PERFORMANCE AND DIFFERS FROM OEM DESIGNS

HYPERTHERM®, Powermax1650®, PowermaxT100®/PowermaxT100M®, Powermax T100®/PowermaxT100H®
are the Registered Trademarks of HYPERTHERM, Inc.

Thermacut is in no way affiliated with the above-named manufacturers. References to the above-named machines, torches, consumables and reference numbers are for convenience only. Most Thermacut parts are made for or by an IBG company. Parts indicated with a * are original parts manufactured by the above named manufacturer and are being resold by Thermacut. Thermacut reserves the right to substitute OEM parts in place of Thermacut parts. Valid from July 2012 • Previous version is no longer valid. • © Copyright 2012 by Thermacut® Czech Republic. All rights reserved.